

Radial Leads Taping Specifications

These radial taped ceramic disc capacitors are designed especially for automatic insertion.

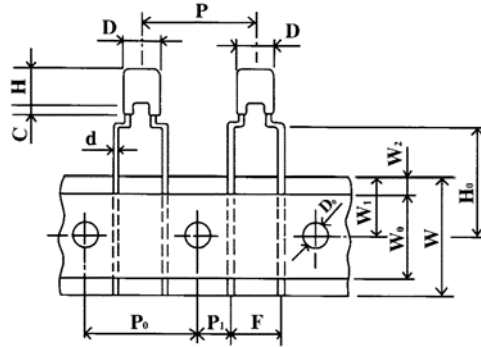

Unit: mm

Item	Symbol	Specification		Remarks
		Value	Tolerance	
Body Width	D	5.0	Max.	
Body Height	H	5.0	Max.	
Lead-wire diameter	d	0.55	±0.05	
Pitch of component	P	12.7	±1.0	
Feed hole pitch	P ₀	12.7	±0.3	Cumulative pitch error: 1.0mm/20pitch
Feed hole center to lead	P ₁	3.85	±0.7	To be measured at bottom of clinch
Lead-to-lead distance	F	5.0	±0.8	
Tape width	W	18.0	+1.0 -0.5	
Hold-down tape width	W ₀	11.0	Min.	
Hole position	W ₁	9.0	±0.5	
Hole-down tape position	W ₂	3.0	Max.	
Height of component from tape center	H ₀	16.0	±0.5	
Feed hole diameter	D ₀	4.0	±0.3	
Coating rundown on leads	C	1.5	Max.	

Anchor with a stapler when the tape is cut or completed. It is accepted that up to three parts may become detached for the tape.

REEL PACKAGE

(3,000 Capacitors per Reel)

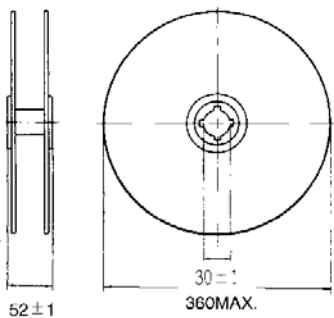

Unit: mm

BOX PACKAGE

(2,000 Capacitors per Box)

